

Co- Break Space City Arena

What is Co – Break Space

Provide a space to give the public time to take a break, in leisure from the alienation of labor, self-expression, through more than 2 athletic activities to promote social communication, thus breaking the diaphragm society

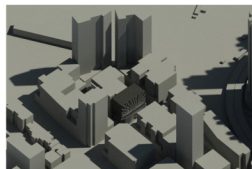

Enjoy the competition with mesh!

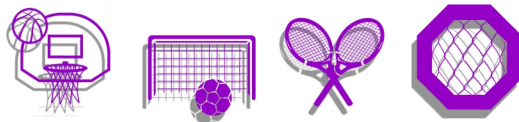

Did You Know?

According to the Codex-Calendar of 354, the Colosseum could accommodate 87,000 people, although modern estimates put the figure at around 50,000. They were seated in a tiered arrangement that reflected the rigidly stratified nature of Roman society.

Information & image reference: <https://en.wikipedia.org/wiki/Colosseum>

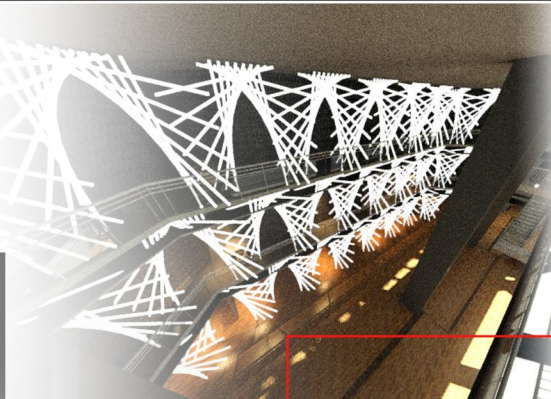

Space Planning

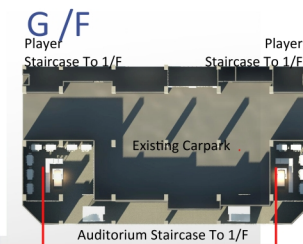

1 / F

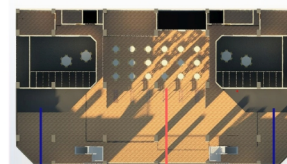

2-3 / F

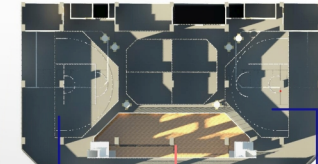

Our Mission: "Take a Break": unwind and a way to relieve stress.
"Break the wall": between people
"Connect": Build connection between people



4 Step to Break the wall

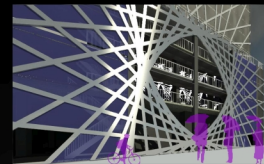
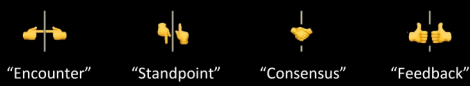

G/F Entrance

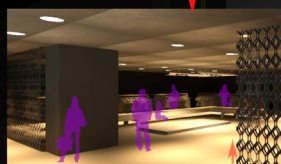

G/F Concept Store

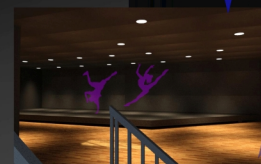

1/F Stage



1/F Communicate Cafe

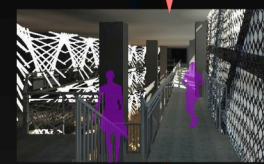

2-3/F Auditorium Bridge



2-3/F Arena



Did You Know?

A bedspace apartment (Chinese: 牀位寓所) also called cage home (籠屋), coffin cubicle or coffin home, is a type of residence that is only large enough for one bunk bed surrounded by a metal cage. In 2007, there were approximately 53,200 people living in cage homes. This type of residence originated in Hong Kong, and primarily exists in older urban districts such as Sham Shui Po, Mong Kok, To Kwa Wan, and Tai Kok Tsui.

Information: https://en.wikipedia.org/wiki/Bedspace_apartment
image reference:
<http://tsuenwandiaries.blogspot.hk/2013/07/caged-homes.html>
<http://www.scmp.com/lifestyle/travel-leisure/article/2108982/hong-kong-cage-homes-hipster-tourists-poverty-tourism-or>



LED Feature Facade

